

THE
RICHWAY
GROUP

Richway & Fuji Bio Inc.
Shaoxing Richway Trading Co.,Ltd.
Richway Europe B.V.
Richway & Life Japan Corp.
R&L Co., Ltd.



User Manual



ORGONE

BIOMAT™

READ AND FOLLOW THE INSTRUCTIONS IN THIS MANUAL TO PREVENT PERSONAL HARM AND PROPERTY DAMAGE.

Contents

- Safety Precautions2**

- Read before operating the product9**
 - Product components9
 - Product description10

- Product installation13**
 - Checklist before product installation13
 - Product installation14
 - Checklist after product installation15
 - Product specifications16

- How to use the product18**
 - Turning ON and OFF18
 - Adjusting the product’s temperature19
 - Adjusting the product’s operation time20

- Useful information22**
 - How to clean and store the product22
 - Trouble shooting guide24
 - Check before contacting customer service24
 - Customer service information25
 - Product manufacturing information25
 - Symbol glossary28
 - Product warranty29

Safety Precautions

Read and follow all instructions in this manual. Proper use of the Orgone Biomat will prevent harm to the user and damage to private property.

The contents are described in three categories: Danger, Warning, and Caution.



Danger

Serious injury or death can occur if instructions are not followed properly.



Warning

Serious injury or death can occur if instructions are not followed properly.



Caution

Property damage and injuries may occur if instructions are not followed properly.



WARNING :

Use carefully. May cause serious burns. Do not use over sensitive skin areas or in the presence of poor circulation. The unattended use of the Orgone Biomat by children or incapacitated persons may be dangerous.

Do not modify or tamper with this device without authorization from the manufacturer.

- If the Orgone Biomat is not working properly, contact your local Customer Service Center.



Danger

Do not alter, change or disassemble the product.

- Doing so may cause the product to malfunction and risks electric shock and fire.

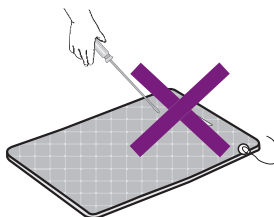

Make sure to use the proper voltage for your country.

- Improper voltage may cause the product to break or risks electric shock and fire.

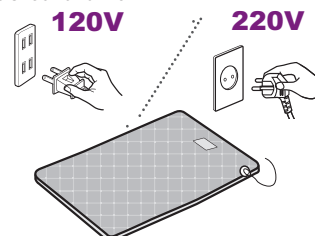

 **Warning**

Be sure the plug is firmly connected to the outlet before operating.

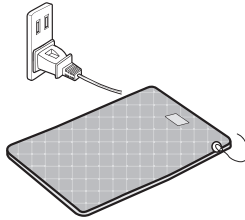

Turn off and unplug the device if the Orgone Biomat catches fire or begins to smoke.

- Report the problem to our Customer Service Center.

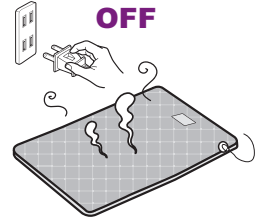

Make sure the power cord is in good condition before using. If there are cuts and tears in the cord do not use.

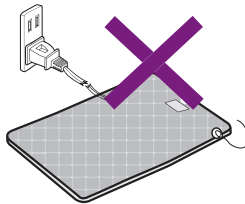

Do not pull on the power cord, controller or the connecting part of the controller and Orgone Biomat.

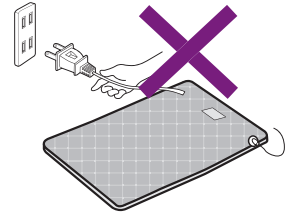

Do not plug the Orgone Biomat into a power strip with other devices. Problems may occur. Plug the Orgone Biomat into a dedicated outlet.

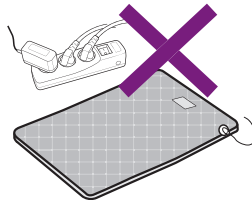

If there is a power outage, turn off the power and disconnect the plug.

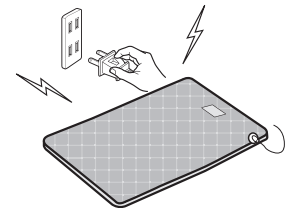

Do not use any metal products such as pins to secure the Orgone Biomat.

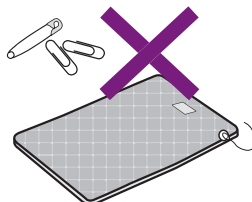

Do not drop, throw, or mishandle the Orgone Biomat controller.

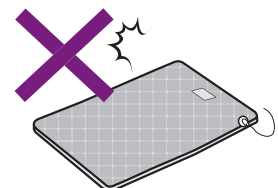

Warning

Do not use the Orgone Biomat in areas where it is very humid or can get wet.

- Doing so may cause electric shock or fire.

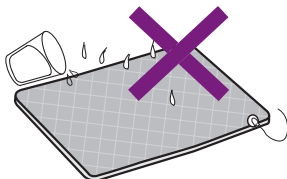

Do not submerge the Orgone Biomat in water to clean. Do not wash the internal heating element portion. To wash the microfiber cover, simply unzip and remove the cover.

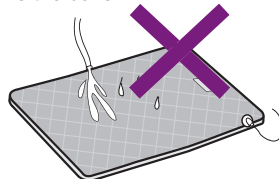

Do not use detergents, solvents, or flammable chemicals when cleaning the Orgone Biomat or controller.

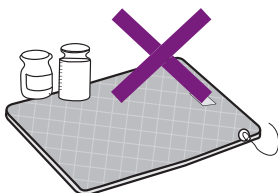

If you do not feel well as a result of using the Orgone Biomat, turn off it and consult with a physician.

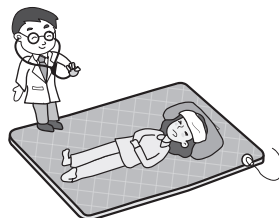

Turn off the Orgone Biomat if you are insensitive to heat. Doing so may cause problems.



Do not use the Orgone Biomat with any ointments, or creams which generate heat. Doing so may cause burns or injury to your skin.



If controller is set to 140°F - 158°F (60° - 70°C), low temperature burns can result if using the Orgone Biomat for a long period of time. Use with caution.



Warning

Store the Orgone Biomat away from children. Do not allow children to wrap the power cord around their necks to prevent serious injury or death by strangulation.

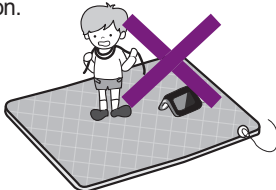

Store the Orgone Biomat away from children. A child can trip and fall over the power cord causing injury to the child and damage to the Orgone Biomat.

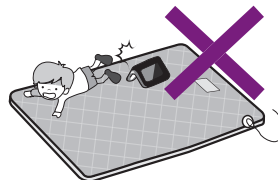

The Orgone Biomat is a medical device and should only be used by a competent adult. Elderly people with difficulty moving need to be supervised.

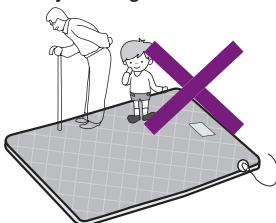

Do not use any auxiliary parts with the Orgone Biomat. This is not permitted and may cause injury, electric shock or fire.

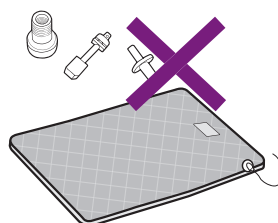

Do not use or connect the Orgone Biomat to any other electronic device. This may cause injury, electric shock or fire.

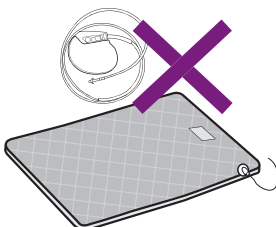



Caution

Keep the Orgone Biomat away from sharp objects. Do not allow anything to puncture the folds of the Orgone Biomat.

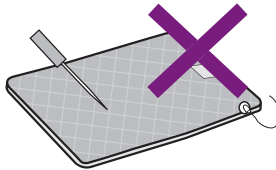

Do not run, stand, or place heavy objects on the Orgone Biomat.

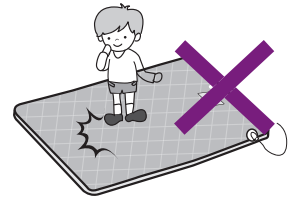

Do not place the controller on the Orgone Biomat when in use. Keep the controller away from the Orgone Biomat.

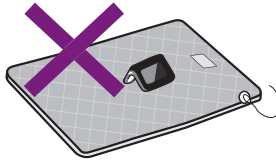

Do not operate the Orgone Biomat near objects which generate heat or magnetic fields such as ventilation from heaters, stoves, TV, magnetic objects, etc...

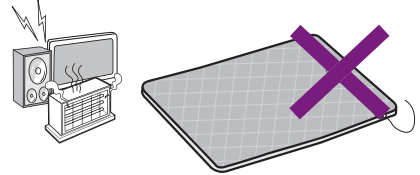

The Orgone Biomat should be stored in an area without humidity and dust.

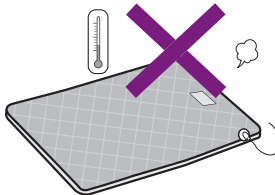

When not in use, turn off the power and unplug the Orgone Biomat.

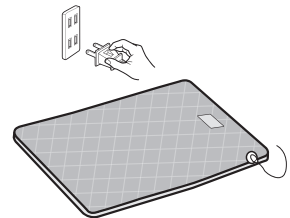



Safety Precautions

1. The Orgone Biomat should not be used by infants and young children. The Orgone Biomat is not indicated for the elderly. The elderly should consult with a physician prior to use.
2. If you have the following conditions, do not use the Orgone Biomat.
 - Person with organ transplants
 - Person with high fever
 - Person with cognitive disability
 - Person with skin problems on the area of use
 - Person with acute disease, acute tumor, the visually impaired, and any heart problems
3. If you have the following conditions, do not use the Orgone Biomat unless directed by a physician.
 - Person with immobility
 - Person with internal pacemaker/defibrillator
 - Person with Adrenal Suppression Disorders, Addison's Disease, Adrenal Insufficiency, Systematic Lupus Erythematosus, and Multiple Sclerosis (MS).
 - Person with bypass surgery
 - Person with serious diabetes
 - Person with high blood pressure (hypertension)
 - Infants
 - Person who is pregnant/expectant
 - Person who recently received radiation/chemotherapy
 - Person with surgical or silicone implants
4. If you have the following conditions, use the Orgone Biomat with caution (no heat/negative ions only).
 - Person with fever
 - Person with joint injuries
 - Person with insensitivity to heat
5. Do not use the Orgone Biomat if your skin is insensitive to temperature change.
6. If using the Orgone Biomat for a long period of time, check your skin to make sure there are no burns or blisters. Stop using the Orgone Biomat if burns or blisters occur.
7. Do not run, stand, or place heavy objects on the Orgone Biomat.
8. Keep the Orgone Biomat away from sharp objects. Do not allow anything to puncture the folds of the Orgone Biomat.
9. Do not pull on the power cord, controller or the connecting part of the controller and Orgone Biomat.
10. Do not alter, change or disassemble the product.
11. Before using the product, inspect the power cord to make sure there is no damage to it.
12. Do not plug the Orgone Biomat into a power strip with other devices. Problems may occur. Plug the Orgone Biomat into a dedicated outlet.
13. Stop using the Orgone Biomat if it is not functioning properly.
14. If there is a power outage, turn off the power and disconnect the plug.
15. If you do not feel well because of the Orgone Biomat, stop using it and consult with a physician.
16. Do not drop, throw, or mishandle the Orgone Biomat controller.
17. Any person who is sick or pregnant/expectant should consult with a physician before using the Orgone Biomat.
18. Do not use the Orgone Biomat if you have an external pacemaker.
19. If controller is set to 140° - 158°F (60° - 70°C), low temperature burns can result if using the Orgone Biomat for a long period of time. Use with caution.
20. When the Orgone Biomat is not in use, unplug it and store it in a dry area without humidity.
21. Unplug the Orgone Biomat before cleaning it. do not wash the internal heating element portion. To wash the microfiber cover, simply unzip and remove the cover.



9 **Before using the product**

9 Product components

10 Product description

RICHWAY GROUP

Read before operating the product

Product components

The product components are described here.

※ The components may change without notice due to product improvement.

Queen / King Orgone Biomat

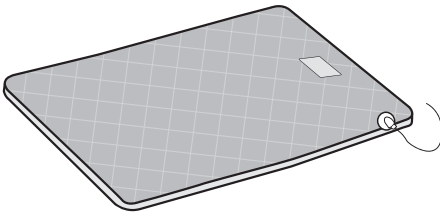

Orgone Biomat

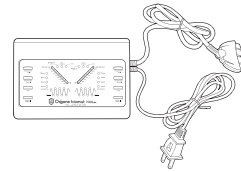

Orgone Biomat Controller / Power Cable

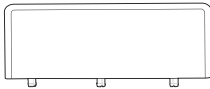

Controller Stand

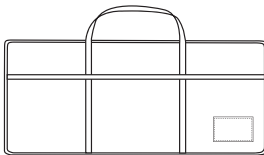

Orgone Biomat Bag



User Manual

※ Orgone Biomat uses the same controller as the Biomat

Product description

Each part of the Orgone Biomat and how to operate it are described here.

Mat

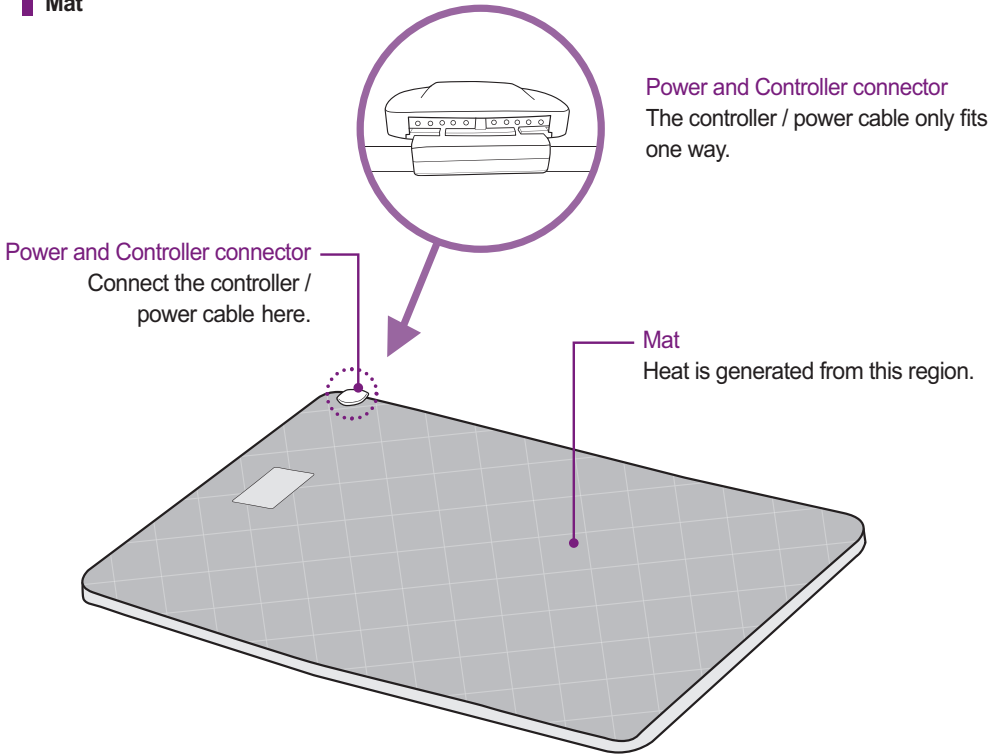

Reference

- The Queen and King Orgone Biomats left and right temperature may be adjusted individually. Direction of the mat and the direction of the controller are shown in the figure on the right.

Controller Front

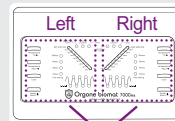

Queen / King Front

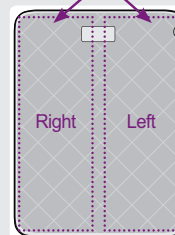

Controller

Queen / King

Temperature indication lamp

The current mat temperature is indicated.
(Indication value: 95° ~ 158°F / 35° ~ 70°C)

Indication lamp

- Infrared ray active (FIR): When the mat temperature is increased, the green color will turn on and if it reaches the set temperature, the lamp will turn off.
- E.M.F. auto block: When the plug is inserted into the correct ground direction, this light will be green.
- Alarm: If any problems are detected during use, this light will flash red.

Temperature adjustment button

Press the Temp Up or Temp Down button to increase or decrease the temperature.

Timer set button

The operation time can be set by pressing this button.
(120V Set value: 2/4/8/12 hrs)

Power button

Turn the mat OFF or ON by pressing this button.

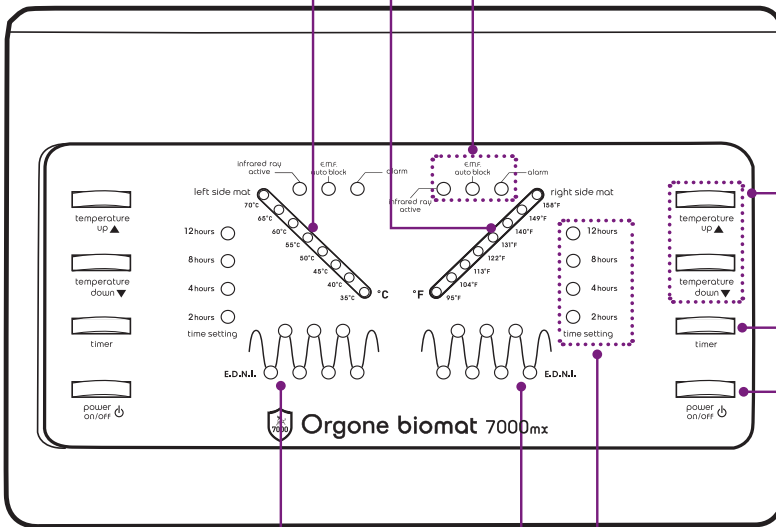

EDNI lamp

When the Orgone Biomat reaches the set temperature, the EDNI lamp will flash in blue.

Timer indicator lamp

The operation time is indicated in green.

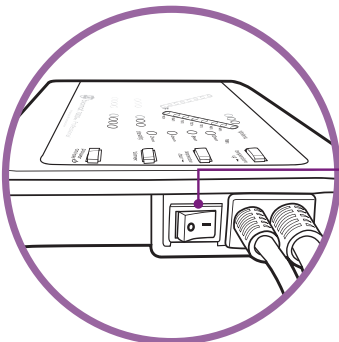

Main power switch

Turn the main power OFF or ON by flipping the switch.
"-" down = ON
"o" down = OFF



ORGONE BIOMAT

13 Product installation

13 Checklist before product installation

14 Product installation

15 Checklist after product installation

16 Product specifications

RICHWAY GROUP

Product installation

Checklist before product installation

Check the following before using the Orgone Biomat.

1. Check if the floor of the area for product installation is flat.

- If used in a non-flat area, the product may be damaged.
- Do not place on surfaces sensitive to heat.

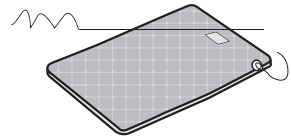

2. Do not use the product in area with high humidity or significant dust.

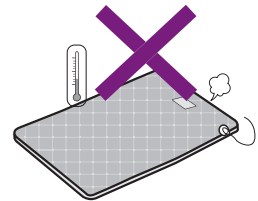

3. Handle the product with care. Any physical impact such as dropping the Orgone Biomat and/or controller can damage internal components.

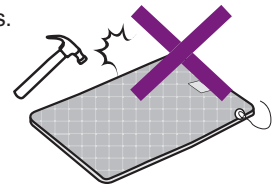

4. Check the voltage before installing the product.

- Voltage for the product: 120V or 220V
- Electric shock or damage to the Orgone Biomat can result from improper voltage.
- The Orgone Biomat's voltage must be the same as the controller's voltage. (120V Orgone Biomat + 120V Controller / 220V Orgone Biomat + 220V Controller)

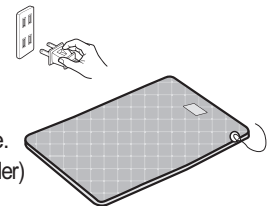

5. Inspect the plug, power cable, and power outlet for any damage.

- Do not use the Orgone Biomat if any of the above is damaged. Electric shock or fire can result from damaged components.

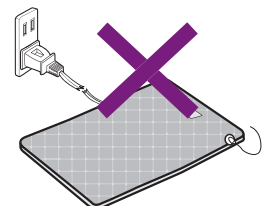

Product installation

To operate the Orgone Biomat follow the steps below.

1. Spread the Orgone Biomat out on a flat area. The side with the ridges should be facing up.

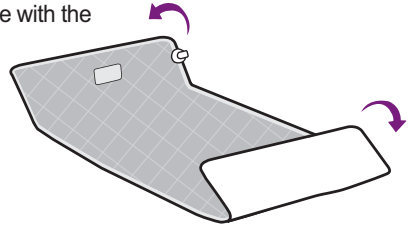

2. Connect the controller / power cable to the connection port of the Orgone Biomat. To ensure a secure connection, there should be no space between the two joinings. The connection may be tight at first.

NOTE: Use care when handling the controller / power cable to prevent accidental breakage. Do not drop, stand on or place heavy objects on the controller / power cable. Never pull the power cable to remove the plug from the receptacle, be sure to hold the plug.

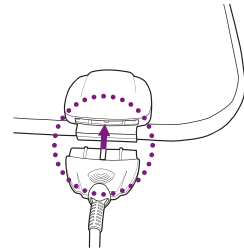

3. Plug the controller / power cable into a 120V or 220V outlet, depending on the voltage of the controller.

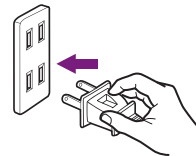

Checklist after product installation

Test the Orgone Biomat.

Queen / King

Check the following to make sure the Orgone Biomat is operating properly.

1. Press the [Main power] switch on the side of the controller to turn on the power of the controller.

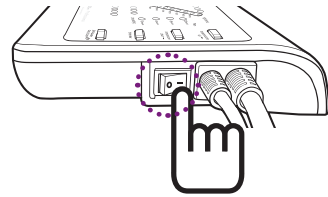

2. Press the [Power] button on the controller and then check for any plug/power system problems.

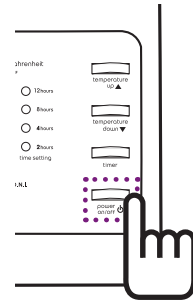

3. Press the [Temperature adjustment] button to see if it is working properly.
 - If the button of the controller is not working properly, please contact our Customer Service Center.

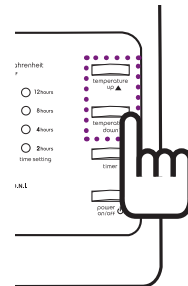

Product specifications

Queen

Category	Contents
Product name	ORGONE BIOMAT
Model name	Queen
Country of manufacturing	Korea
Product size	1500 x 2000 mm
Manufacturing number and manufacturing date, weight or packing unit	1) Record after manufacturing 2) Weight: 15KG, packing unit: 1 set
Operating temperature	95° ~ 158°F / 35° ~ 70°C
Capability and how to use	1) Capability: Refer to the manual 2) How to use: Refer to the manual
Precaution on use	Refer to the manual
Method of keeping and storage	Refer to the manual
Phase, frequency, rated voltage of rated power	120V~, 60Hz, 360 W

King

Category	Contents
Product name	ORGONE BIOMAT
Model name	King
Country of manufacturing	Korea
Product size	1800 x 2000 mm
Manufacturing number and manufacturing date, weight or packing unit	1) Record after manufacturing 2) Weight: 20KG, packing unit: 1 set
Operating temperature	95° ~ 158°F / 35° ~ 70°C
Capability and how to use	1) Capability: Refer to the manual 2) How to use: Refer to the manual
Precaution on use	Refer to the manual
Method of keeping and storage	Refer to the manual
Phase, frequency, rated voltage of rated power	120V~, 60Hz, 360 W



ORGONE BIOMAT

18 How to use the product

18 Turning ON and OFF

19 Adjusting the product's temperature

20 Adjusting the product's operation time

RICHWAY GROUP

How to use the product

Turning ON and OFF

Queen / King

The Queen / King Orgone Biomat is designed for two person use. The left and right sides of the mat can be adjusted independently. The temperature and usage time can be set independently to save energy.

1. Press the power switch on the side of the controller to the (-) direction to turn on the power.

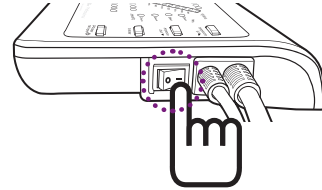

2. Turn the Orgone Biomat on by pressing the [Power] button on the controller of the side you want.

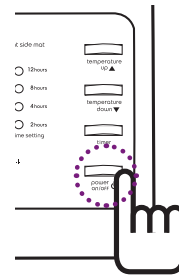

Caution

- Please check if the E.M.I./E.M.F. lamp is illuminated when the power is connected. If the lamp is not turned on after turning on the Orgone Biomat, please contact Customer Service.
- When connecting the controller / power cable, check if the E.M.I./E.M.F. auto block lamp is on. For 220V mats: If the E.M.I./E.M.F. auto block lamp does not turn on green even after power connection, unplug and re-insert the power plug in the opposite direction.
- When the 158°F / 70°C LED lamp is flashing after power connection, check if the controller and mat are properly and securely connected. To ensure a secure connection, there should be no space between the two joinings. The connection may be tight at first.
 - If the power does not turn on, unplug and re-connect the power plug again.
 - If the power does not turn on, check if the outlet voltage is the proper voltage.

If the power still does not turn on after using the methods stated above, please contact the Customer Service Center.

Recommended usage:

- We recommend first time users to start at a low temperature and work your way up to your own comfort level.
- We do not recommend sleeping on high temperatures all night.

Adjusting the product's temperature

1. When the power is turned on, press the [Temperature Up / Down] button to set the desired temperature.

- Range of temperature:
Queen / King: 95° ~ 158°F / 35° ~ 70°C
- When the [Temperature Up] button is pressed once, the temperature is increased 5°C (9°F) at a time, and when the [Temperature Down] button is pressed once, the temperature is decreased 5°C (9°F).

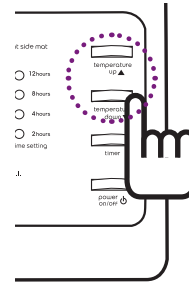

2. When adjusting the temperature, the indicator lamp will change color depending on the temperature chosen.

- Set for 95° ~ 104°F (35° ~ 40°C): The blue light is illuminated on the temperature indication part of the controller.
- Set for 113° ~ 122°F (45° ~ 50°C): The green light is illuminated on the temperature indication part of the controller.
- Set for 131° ~ 140°F (55° ~ 60°C): The orange light is illuminated on the temperature indication part of the controller.
- Set for 149° ~ 158°F (65° ~ 70°C): The red light is illuminated on the temperature indication part of the controller.

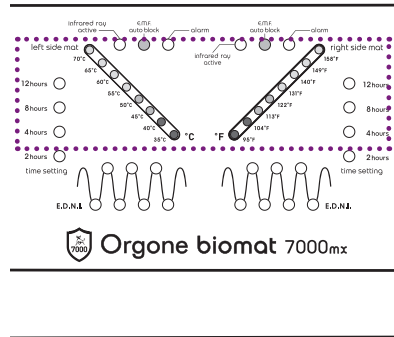

3. Once selected, the Orgone Biomat will heat to the proper temperature.

4. When the temperature value reaches the set temperature, the EDNI lamp will flash in blue (Queen / King sizes only).

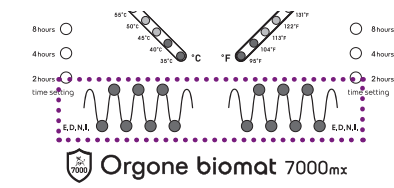

Adjusting the product's operation time

- After setting the operation temperature, press the [Timer] button to adjust and set the desired operation time within the set value.

- Range of operation time: 2 / 4 / 8 / 12 hours
Basic set value: 8 hours

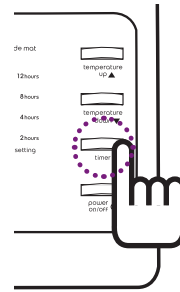

- When the operation time is set, the timer indication lamp will illuminate depending on the set value.

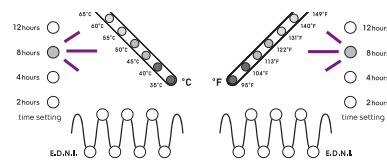

 **Orgone biomat 7000mx**

- When the set time has lapsed, it will stop the operation and the power is automatically turned off.

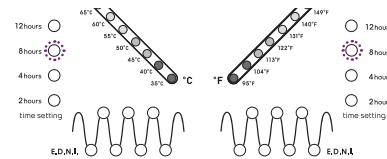

 **Orgone biomat 7000mx**



Reference

- When using the Orgone Biomat, if the timer is set for 8 or 12 hours at 131°F (55°C) or higher, it will automatically decrease the temperature to 113°F (45°C) or below after 4 hours of use for the safety of the user. When the set time is reached, the power will turn off.



ORGONE BIOMAT

22 Useful information

22 How to clean and store the product

24 Trouble shooting guide

24 Check before contacting customer service

25 Customer service information

25 Product manufacturing information

28 Symbol glossary

29 Product warranty

RICHWAY GROUP

Useful information

How to clean and store the product

Check after using the Orgone Biomat

- After using the Orgone Biomat, turn it off by pressing the Power button.
- When the power is turned off, separate the power plug from the outlet.

How to clean the Orgone Biomat

1. Unzip and remove the microfiber cover.

- Do not mix with other products when laundering.
- Turn cover inside out.
- Wash it alone with warm water at a temperature of 86°F~104°F (30°C~40°C).
- Use a neutral detergent instead of bleach or dye.
- Hand wash preferred.
- In case of machine wash, choose wool settings to wash, lightly wring and lay down in shade to dry.
- Please note this product is made of flammable materials and that you need to be cautious about fire and flammables.
- Be careful when handling with product since sharp objects such as knives or needles may cause damage.
- Do not leave any moisture on the Orgone Biomat after washing the product.

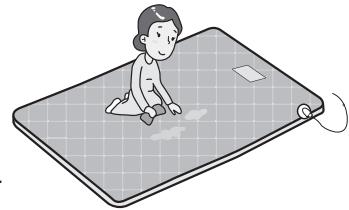

2. We recommend washing the microfiber cover of the Orgone Biomat once a month to maintain good condition.

- In case of machine wash, choose wool settings to wash, lightly wring and lay down in shade to dry.



Caution

- When cleaning the Orgone Biomat, do not wash or dry clean the internal heating element.
- Doing so may cause damage, electric shock or short circuit.

How to store the Orgone Biomat

- Store the Orgone Biomat lying flat (not folded) and in a well ventilated area.
- If you must fold the Orgone Biomat, do so the same way as you received it. Folding it in the opposite direction may cause the internal circuitry to break.
- Separate the controller from the Orgone Biomat and place it in a bag.



Caution

- In the event that the controller and stand are separated, make sure to separate by pulling in the other direction from the direction where the stand is integrated.

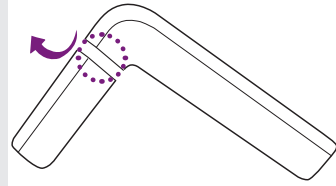

Product Storage/Transportation

The Orgone Biomat has to be stored and transported according to the following appropriate conditions.

Product Storage/ Transportation	- Storage Temperature: 32° ~ 113°F / 0° ~ 45°C - Transportation Temperature: -13° ~ 158°F / -25° ~ 70°C - Humidity: 15% ~ 93% - Air pressure: 700 ~ 1060 hPa
	- Place without humidity and out of direct sunlight - Place without dust and with good ventilation.



Caution

- Before moving the Orgone Biomat, be sure to turn it off and wait until it has cooled down.

Trouble shooting guide

If the alarm lamp on the controller flickers while using the Orgone Biomat, follow this guide. If the alarm lamp continues to flicker after following the methods below, stop use of the product and contact Customer Service.

Queen / King

Indicator Lamp	Cause	Resolution method
Alarm lamp is flickering in red	Orgone Biomat connection is not secure	<ul style="list-style-type: none"> Check if the Orgone Biomat cable is appropriately connected to the controller.
	Defective temperature sensor	<ul style="list-style-type: none"> Temperature sensor wire is broken. Contact our Customer Service Center.

Check before contacting customer service

If there is any malfunction during the use of the product, check the following contents before contacting our Customer Service Center.

Symptom	Resolution method
The power switch is turned on but the power indicator light is not turned on.	<ul style="list-style-type: none"> Check if the power plug is securely connected to the outlet. Check if the voltage of the outlet is 120V Connect the power plug correctly, but if it still does not properly work, contact our Customer Service Center.
The temperature is set but the Orgone Biomat is not working.	<ul style="list-style-type: none"> Check if the Orgone Biomat and the controller are correctly connected. Turn off the power of the controller and separate the power cable and then re-connect again. Connect the power cable correctly, but if it still does not properly work, contact our Customer Service Center.
During the use of the Orgone Biomat, the power suddenly turns off.	<ul style="list-style-type: none"> Turn the power off and turn it on again.
The alarm lamp has the red light on and the Orgone Biomat is not working.	<ul style="list-style-type: none"> If the alarm lamp is on, turn off the power immediately and separate the power cable and then contact our Customer Service Center.

Customer service information

If your Orgone Biomat is not working properly call our Customer Service Center.

CUSTOMER SERVICE CENTER

North America & International

Richway & Fuji Bio Inc.

Tel: 1-808-589-2800

Toll-Free: 1-855-338-6410 (USA, Canada, Guam, Saipan)

Homepage: www.richwayandfujibio.com

Email: rma@richwayusa.com

China

Shaoxing Richway Trading Co., Ltd.

Tel: +86-575-8110-1350

Europe

Richway Europe B.V.

Tel: +31-(0)20-658-6231

International: +31-(0)20-303-3411

Product manufacturing information

The certificate of complete product manufacturing is attached to the rear side of the controller and the rear side of the Orgone Biomat.

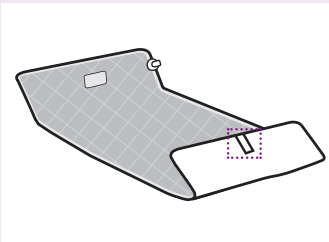

Rear side of Orgone Biomat

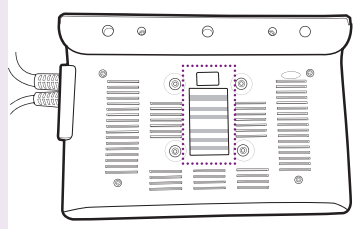

Rear side of Controller

QUEEN

Front



Side



Product Information

Product Name: Orgone Biomat
 Manufactured by: R&L CO
 Address: 121, Aca Gasangmyong Tower B, 108 Heamw, Gwangmyong-Gu, Gyeonggi-Do, Korea 14319
 TEL: 82-2-8111-0700 www.richwayandfjbio.com

Distributed by: RICHWAY & FUJI BIO INC.
 1214 SOUTH KING STREET SUITE 320 HONOLULU, HI 96814
 TEL: 1-808-589-2800 FAX: 1-808-597-1603
 www.richwayandfjbio.com
 www.richwayandfjbio.com
 Size: Orgone Biomat Queen 2002 x 1500mm
 Orgone Biomat King 2002 x 1800mm

Cover: 100% Microfiber(Kevlar)

How to wash



- Do not mix with other products when laundering
- Separate cover and cushion
- Turn cover inside out
- Wash it alone with warm water at a temperature of 80°F-104°F (30°C-40°C)
- Use a milder detergent instead of bleach or dye.
- Hand wash preferred
- In case of a machine wash, choose wool setting to wash lightly, wring and lay down to dry
- Please note that this product is made of flammable materials and that you need to be cautious about fire and flammables
- Be careful when handling this product since sharp objects such as knife or needles may damage

MADE IN KOREA

물질안전 및 건강을 위한 관리법에 관한 통지서

제품명 오로곤 바이오매트
 제조업: (주)리얼컴
 주 소: 경기도 고양시 덕양구 아산로 108
 (리얼컴 바이오인텔리전스 빌딩 11층)
 TEL: 82-2-8111-0700, www.richwayandfjbio.com

사이즈: 오로곤 바이오매트 퀸 2002 x 1500mm
 오로곤 바이오매트 킹 2002 x 1800mm

기 타: 100% 마이크로파이버 (폴리에스터/레이)

세탁안내 및 주의사항



- 다른 제품들과 혼합하여 세탁하지 마세요
- 세탁할 때에는 반드시 세탁망을 사용하세요
- 세탁의 경우 부드러운 세탁제를 사용하세요
- 30°C-40°C(86°F-104°F)의 온도에서 세탁하세요
- 락스, 염색제 등을 사용하지 마세요. 증착제를 사용하지 마세요
- 손세탁을 권장합니다
- 기계세탁시 울류스 세탁제(스프레이)를 사용하시면 더 오래 쓸 수 있습니다
- 본 제품을 가열할 수 있는 불, 화기로부터 주의하세요
- 이 제품 및 통지서 뒷면에 제품사용에 관한 지침이 있으니 꼭 읽어주세요

MADE IN KOREA

CAUTION

TO REDUCE THE RISK OF ELECTRIC SHOCK, DO NOT OPEN THE PANEL. NO USER SERVICEABLE PARTS INSIDE. REFER SERVICING TO QUALIFIED PERSON.

READ INSTRUCTIONS CAREFULLY

Product : Orgone Biomat Queen
 Voltage : 120Volts
 Electric Consumption : 360Watts
 Frequency : 50Hz
 Manufacturer : R & L Corporation
 Distributed by : RICHWAY & FUJI BIO INC.
 Address : 1214 South King Street Suite 320 Honolulu, HI 96814 U.S.A
 Tel : 808 589 2800
 Origin : Made in Korea

RICHWAY & FUJI BIO INC.
 www.richwayandfjbio.com



KING

Front



Side



Product Information

Product name : Orgone Biomat
 Manufactured by : R&L CO.
 Address : 111 An-dong, Gyeongju Town 8, 108 Haein-ro,
 Gyeongju-si, Gyeongju-do, Korea 71415
 TEL : 82-7611-7700 www.richwaykorea.com

Distributed by : RICHWAY & FUJI BIO INC.
 1314 SOUTH KING STREET SUITE 520 HONOLULU, HI 96814
 TEL : 1-808-589-2800 FAX : 1-808-587-4551
 www.richwayandfujibio.com
 Size : Orgone Biomat Queen : 2000 X 1500mm
 Orgone Biomat King : 2000 X 1800mm

Cover : 100% Microfiber Polyester

How to wash



- Do not mix with other products when laundering
- Separate cover and cushion
- Turn cover inside out
- Wash in 40°C with warm water at a temperature of 60°-104° (18°C-40°C)
- Use a neutral detergent instead of bleach or dye.
- Hand wash preferred
- In case of a machine wash, choose wool setting to wash lightly, wring and lay down in shade to dry
- Please note that this product is made of flame-retardant material, and that you need to be cautious about fire and ferrous metal.
- Be careful when handling this product since sharp objects such as knife or needles may damage

MADE IN KOREA

품질경영 및 공산품 안전 관리법에 의한 품질표시

제품명 : 오르곤 바이오 매트
 제조물 (주요) 명명
 주 소 : 경기도 평택시 죽미산 108
 (오르곤 바이오스쿨타워 11층)
 TEL : 02-6112-7700, www.richwaykorea.com

사치인 : 오르곤 바이오 매트 매트 2000 X 1500mm
 오르곤 바이오 매트 매트 2000 X 1800mm

기 비 : 100% 인더크로로화인더 (폴리에스테르)

세탁안내 및 주의사항



- 다른 제품과 혼합해서 세탁하지 마세요.
- 커버와 쿠션은 분리해서 세탁하세요.
- 쿠션은 항상 뒤집어서 세탁하세요.
- 30°C-40°C의 미온수를 사용하여 단독 세탁하세요.
- 고온 세탁제를 사용하지 마시고 중성세제를 사용하세요.
- 손세탁을 권장합니다.
- 기계세탁이 불가할 경우 울크로스 세탁시키고 세탁하면 뒤 그늘에 널어서 건조하세요.
- 전 제품을 가연성 소재로 불, 화기로부터 주의하세요.
- 제품 중 일부 액세서리 물건의 제품보증서가 있을 수 있으나 취급 시 주의하세요.

MADE IN KOREA

CAUTION

TO REDUCE THE RISK OF ELECTRIC SHOCK,
 DO NOT OPEN THE PANEL.
 NO USER SERVICEABLE PARTS INSIDE,
 REFER SERVICING TO QUALIFIED PERSON.











READ INSTRUCTIONS CAREFULLY

Product : Orgone Biomat King
 Voltage : 120V/60Hz
 Electric Consumption : 360Watts
 Frequency : 60Hz
 Manufacturer : R & L Corporation
 Distributed by : RICHWAY & FUJI BIO INC.
 Address : 1314 South King Street Suite 520
 Honolulu, HI 96814 U.S.A
 Tel : 808 589 2800
 Origin : Made in Korea

RICHWAY & FUJI BIO INC.
 www.richwayandfujibio.com



Symbol glossary

Symbol	Meaning
	Symbols of general warning
	General warning sign
	Type BF Applied part
~	Alternating Current
	Waste disposal
	Stepping prohibited
	Sitting prohibited
	Keep dry
	Serial Number
	“ON” (power) To indicate connection to the main power source, at least for mains switches or their positions, and all those cases where safety is involved.
○	“OFF”(power) To indicate disconnection from the main power source, at least for mains switches or their positions, and all those cases where safety is involved.
	Stand-by To indicate the switch or switch position by means of which part of the equipment is switched on in order to bring it into the stand-by condition.
	Refer to instruction manual

Indications for use

The Orgone Biomat is an electrical device intended for rest and relaxation while sleeping. It provides dry heat for body surfaces. It is capable of maintaining an elevated temperature during use.

Product warranty

Order information	Product name	Orgone Biomat	Model name	
	Warranty period	Limited 3 years from the date of product purchase	Manufacturing number	
	Date of purchase		Branch of purchase	
Customer information	Name		Purchase price	

Richway & Fuji Bio warrants the covered product to be free from defects and malfunctions at the time sold. "Defects" as used in this warranty, is defined as imperfections, which impair or impede the function and use of the product.

How Long the Warranty Lasts

This warranty lasts 3 years from the date of delivery. This warranty extends to the original purchaser only. Coverage terminates if you sell or otherwise transfer ownership.

What This Warranty Covers

This warranty covers any defects or malfunctions in the electronic components, heating element, and top cover replacement. If Richway & Fuji Bio determines that such goods are defective, within the period of this warranty, Richway & Fuji Bio will repair or replace the parts free of charge for the first year. Repair or replacement for the second and third year requires a fee, which can be found on our website. Repair or replacement is the sole and exclusive remedy available to the buyer, and shall constitute the fulfillment of all Richway & Fuji Bio obligations in respect to the goods furnished under this agreement.

What This Warranty Does Not Cover

This warranty does not cover abuse, misuse, natural disaster, insufficient or excessive electrical supply, ordinary wear, fading, failure to follow instructions and improper maintenance. Richway & Fuji Bio shall not be liable for any incidental or consequential damages as a direct result of negligence or misuse. This warranty does not extend to the purchase of opened, used, repaired, repackaged, and/or resealed products, including but not limited to sale of such products on internet sites and/or sales of such products on internet auction sites and/or sales of such products by surplus or bulk resellers. Any and all warranties or guarantees shall immediately cease and terminate as to any products or parts thereof which are repaired, replaced, altered, or modified, without the prior express and written consent of Richway & Fuji Bio.

How to Get Service

To obtain service under this warranty, contact your local Customer Service Center and provide the purchaser's name, RI (Richway Invoice) number, and a detailed description of the problem you are experiencing. They will provide you with a return merchandise authorization number (RMA). This number is required and must be placed in a visible area on the front of the package. Ship your product postage paid, include a copy of the original sales slip, credit card receipt or other proof of the date of the original retail purchase. If servicing within the first two (2) months, we will send you a prepaid shipping label to cover your shipping costs. If servicing from the third month and on, the customer is responsible for shipping costs to return the product for repair or replacement. We will cover the shipping costs to return the product back to the customer.

How Do State Laws Apply

This warranty gives you specific legal rights, and you may also have other rights which vary from state to state. Any implied warranties last the duration of this warranty. Some states do not allow limitations on how long an implied warranty lasts and some states do not allow the exclusion or limitation of incidental or consequential damages, so the limitations or exclusions may not apply to you.

THE
RICHWAY
GROUP

RICHWAY & FUJI BIO INC.

1314 South King Street Suite 520, Honolulu, HI 96814 USA

Tel: 1-808-589-2800/ Toll-Free: 1-855-338-6410

Homepage: www.richwayandfujibio.com



Manufacturer: R&L Co., Ltd.

Address: 11F, Ace Gwangmyeong Tower B, 108 Haan-Ro,
Gwangmyeong-Si, Gyeonggi-Do, Korea 14319

READ AND FOLLOW THE INSTRUCTIONS IN THIS MANUAL TO PREVENT PERSONAL HARM AND PROPERTY DAMAGE.